

FEATURES

- Bartenbach 'Dark Light' technology
- Low UGR levels combined with high light output

Bartenbach
lighting optics



SPRINGS

Standard with CS spring (concrete/gyproc). Also available as above with WS spring (gyproc/metal).

COLOURS

Available colours:



Nr	Housing	Inside ring
RAL 9016		
XX=61	Matt white / Gold	
XX=63	Matt white / Silver	
XX=62	Matt white / Black	
XX=65	Matt white / White	



Nr	Housing	Inside ring
RAL 9005		
XX=71	Matt black / Gold	
XX=74	Matt black / Silver	
XX=72	Matt black / Black	
XX=76	Matt black / White	

Strada 35

Fixed

SPECIFICATIONS

Beam angle (FWHM)	40° (65° FWTM)
Fixture material	Housing: Die cast aluminium / Reflector glass: Polycarbonate
Environment	Indoor
IK rate	IK03
Operating temperature (Ta)	-20°C / +45°C 1
Safety marks	EN60598 / EN62031 / EN62471
EMC compliance	EN55015
Colour consistency (SDCM)	MacAdam step 3
Warranty	7 years * (within the European Union and the countries of the Free Trade Association for products delivered after 1 May 2015)
Energy class	These products contain a light source of energy efficiency class F (2700K/3000K) / E (4000K)

This luminaire contains built-in LED lamps. There are no exchangeable parts inside the luminaire. EU 874/2012

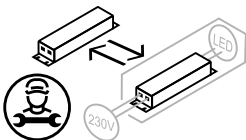

Only when the product is installed in a closed ceiling it may be exposed to water splashes, and only on its front side.



STRADA 35 VARIATIONS

Strada 35 LV	CRI93 110-240V	incl. power supply	page 3
Strada 35 LVC	CRI93 500mA	to be connected to a central power supply	page 4
Strada 35 LV	CRI82 110-240V	incl. power supply	page 5
Strada 35 LVC	CRI82 500mA	to be connected to a central power supply	page 6

DIMENSIONS

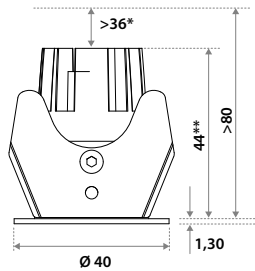

* This distance is necessary because of the height of the connection box (80 mm). For purely heat reasons just 5 mm is sufficient.
** For WS springs this dimension is 60 mm

CUT-OUT



Using CS springs: Ø 35 mm.
Thickness ceiling 5-80 mm
& recess depth 80 mm.



Using WS springs: Ø 36 mm.
Thickness ceiling 1-50 mm
& recess depth 80 mm.

STRADA 35 (dimmable - incl. individual power supply)

CRI93 / 110-240V

Downlight incl. PSU

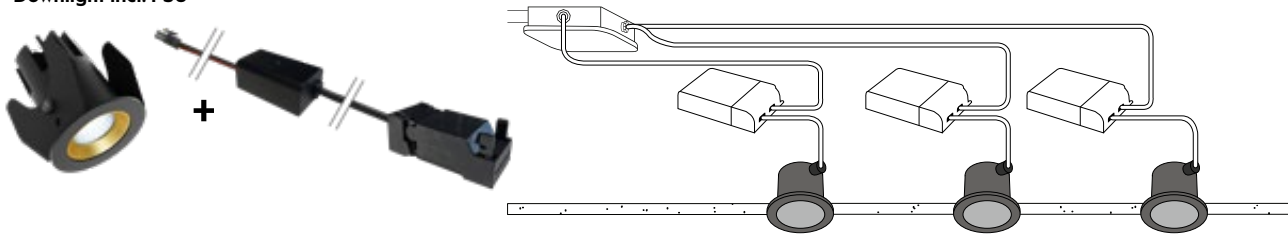

ITEM SPECIFICATIONS (PART A)

Description	Item code CS	Item code WS	Input	W	Lm	Lm/W	CRI (typ.)	UGR	Pf	Ripple	Inrush current	B-16A Fuse
Strada 35 LV 450 Lm 2700K CRI93 No dim	853Y03XX0102	853Y03XX1A02	100-240V	6,6	450	69	93	14.8	0.88	<3%	20A 170µs	50 pcs
Strada 35 LV 475 Lm 3000K CRI93 No dim	853Y03XX7202	853Y03XX2A02	100-240V	6,6	475	73	93	15.0	0.88	<3%	20A 170µs	50 pcs
Strada 35 LV 500 Lm 4000K CRI93 No dim	853Y03XX0202	853Y03XX3A02	100-240V	6,6	500	76	93	15.2	0.88	<3%	20A 170µs	50 pcs

ITEM SPECIFICATIONS (PART B)

Description	Safety class	Energy class	Weight	Dimensions single carton	Quantity per carton	Expected Lifetime			Reported Lifetime*		
						L70B10	L80B10	L90B10	L70B10	L80B10	L90B10
Strada 35 LV 2700K CRI93	II	F	172 gr	105x105x61 mm	42 pcs	177.000 hrs	113.000 hrs	51.000 hrs	>102.000 hrs	>102.000 hrs	51.000 hrs
Strada 35 LV 3000K CRI93	II	F	172 gr	105x105x61 mm	42 pcs	177.000 hrs	113.000 hrs	51.000 hrs	>102.000 hrs	>102.000 hrs	51.000 hrs
Strada 35 LV 4000K CRI93	II	E	172 gr	105x105x61 mm	42 pcs	177.000 hrs	113.000 hrs	51.000 hrs	>102.000 hrs	>102.000 hrs	51.000 hrs

All values are measured at 230V (+/- 7%). *Based on 17.000hrs of LM80 testing at 700mA and a Tc85 °C.

INCL. PSU NO DIM (100-240V)

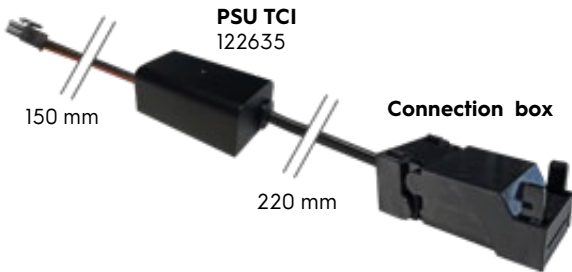

STRADA 35 (dimmable - excl. central power supply)

CRI93 / 500 mA

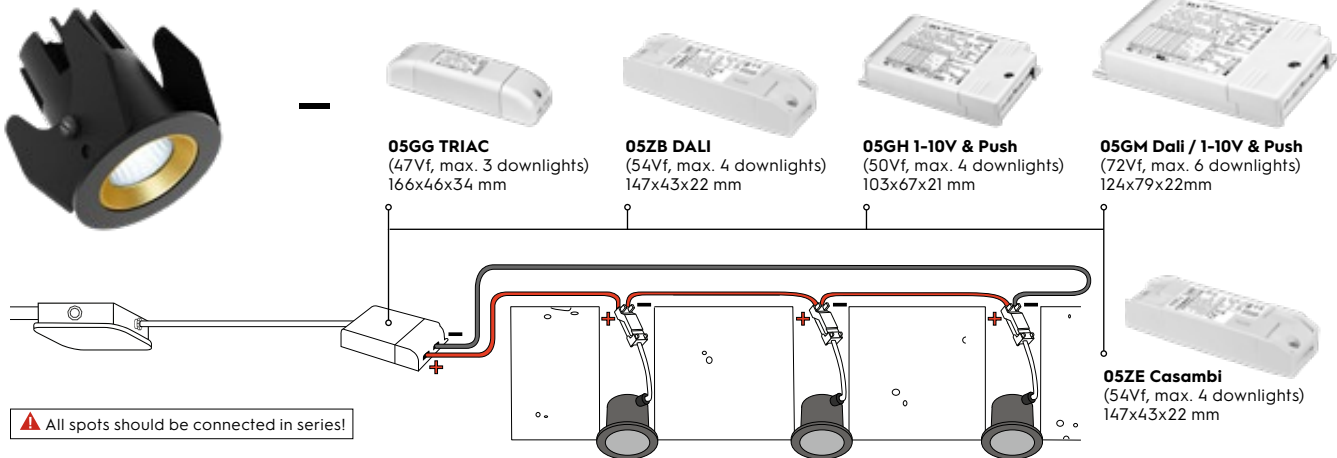

ITEM SPECIFICATIONS (PART A)

Description	Item code CS	Item code WS	Input	Vf	W	Lm	Lm/W	CRI (typ.)	UGR	Pf	Ripple	Inrush current	B-16A Fuse
Strada 35 LVC 500mA 450 Lm 2700K CRI93 Dim	853Y03XX01E2	853Y03XX1AE2	500mA	11,9	5,7	450	79	93	14,8	x	x	x	x
Strada 35 LVC 500mA 475 Lm 3000K CRI93 Dim	853Y03XX72E2	853Y03XX2AE2	500mA	11,9	5,7	475	83	93	15,0	x	x	x	x
Strada 35 LVC 500mA 500 Lm 4000K CRI93 Dim	853Y03XX02E2	853Y03XX3AE2	500mA	11,9	5,7	500	88	93	15,2	x	x	x	x

ITEM SPECIFICATIONS (PART B)

Description	Safety class	Energy class	Weight	Dimensions single carton	Quantity per carton	Expected Lifetime			Reported Lifetime*		
						L70B10	L80B10	L90B10	L70B10	L80B10	L90B10
Strada 35 LVC 500mA 2700K CRI93	III	F	150 gr	105x105x61 mm	42 pcs	177.000 hrs	113.000 hrs	51.000 hrs	>102.000 hrs	>102.000 hrs	51.000 hrs
Strada 35 LVC 500mA 3000K CRI93	III	F	150 gr	105x105x61 mm	42 pcs	177.000 hrs	113.000 hrs	51.000 hrs	>102.000 hrs	>102.000 hrs	51.000 hrs
Strada 35 LVC 500mA 4000K CRI93	III	E	150 gr	105x105x61 mm	42 pcs	177.000 hrs	113.000 hrs	51.000 hrs	>102.000 hrs	>102.000 hrs	51.000 hrs

ITEM SPECIFICATIONS (PART A)

Description	Item code	Input	Watt	Current	Efficiency	Pf	Ripple	Weight	Inrush current	B-16A Fuse
PSU 24W 500mA Triac	05GG03MLME00	220-240V	24W (47Vf)	500mA	85%	0,97	<3%	138 gr	5A 50µS	50 pcs
PSU 27W 500mA Dali	05ZB03MLME00	220-240V	27W (54Vf)	500mA	89%	0,95	<3%	139 gr	5A 50µS	50 pcs
PSU 25W 500mA 1-10V & Push	05GH03MLME00	220-240V	25W (50Vf)	500mA	88%	0,95	<3%	138 gr	5A 50µS	50 pcs
PSU 27W 500mA Casambi	05ZE03MLME00	220-240V	27W (54Vf)	500mA	89%	0,95	<3%	139 gr	5A 50µS	50 pcs
PSU 35W 500mA Dali / 1-10V & Push	05GM03MLME00	220-240V	35W (72Vf)	500mA	89%	0,95	<3%	218 gr	10A 200µS	30 pcs

All values are measured at 230V (+/- 7%). *Based on 17.000hrs of LM80 testing at 700mA and a Tc85 °C.

INCLUDING CONNECTION BOX

For installation to a central power supply.

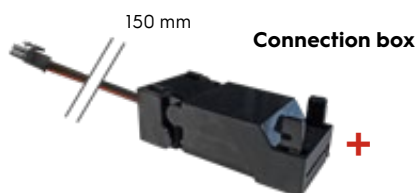

STRADA 35 (dimmable - incl. individual power supply)

CRI82 / 110-240V

Downlight incl. PSU

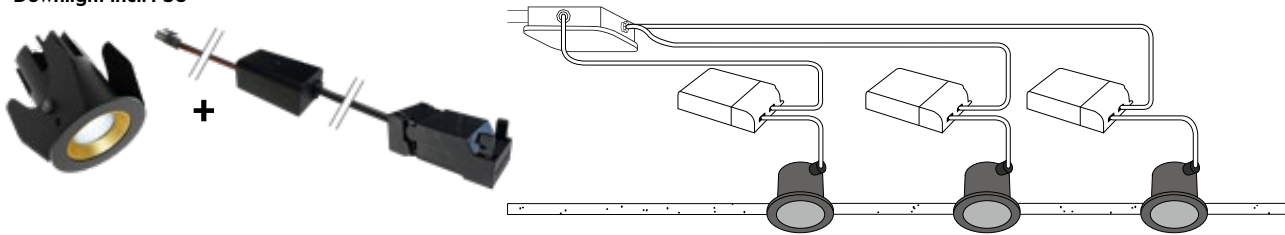

ITEM SPECIFICATIONS (PART A)

Description	Item code CS	Item code WS	Input	W	Lm	Lm/W	CRI (typ.)	UGR	Pf	Ripple	Inrush current	B-16A Fuse
Strada 35 LV 475 Lm 2700K CRI82 No dim	851903XX0102	851903XX1A02	100-240V	6,6	475	72	82	15.0	0.88	<3%	20A 170µs	50 pcs
Strada 35 LV 500 Lm 3000K CRI82 No dim	851903XX7202	851903XX2A02	100-240V	6,6	500	76	82	15.2	0.88	<3%	20A 170µs	50 pcs
Strada 35 LV 525 Lm 4000K CRI82 No dim	851903XX0202	851903XX3A02	100-240V	6,6	525	80	82	15.4	0.88	<3%	20A 170µs	50 pcs

ITEM SPECIFICATIONS (PART B)

Description	Safety class	Energy class	Weight	Dimensions single carton	Quantity per carton	Expected Lifetime B10 reported (25°C)		
						L70B10	L80B10	L90B10
Strada 35 LV 475 Lm 2700K CRI82 No dim	II	F	172 gr	105x105x61 mm	42 pcs	>60.000 hrs	>60.000 hrs	>60.000 hrs
Strada 35 LV 500 Lm 3000K CRI82 No dim	II	F	172 gr	105x105x61 mm	42 pcs	>60.000 hrs	>60.000 hrs	>60.000 hrs
Strada 35 LV 525 Lm 4000K CRI82 No dim	II	E	172 gr	105x105x61 mm	42 pcs	>60.000 hrs	>60.000 hrs	>60.000 hrs

All values are measured at 230V (+/- 7%). Available from Q3 2020.

INCL. PSU NO DIM (100-240V)

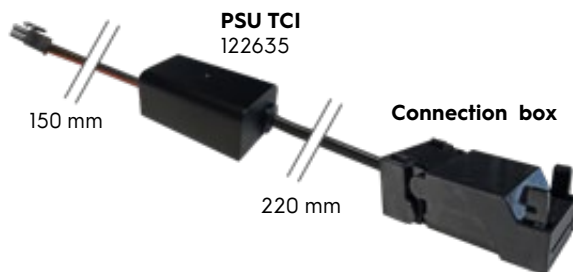

STRADA 35 (dimmable - excl. central power supply)

CRI82 / 500 mA

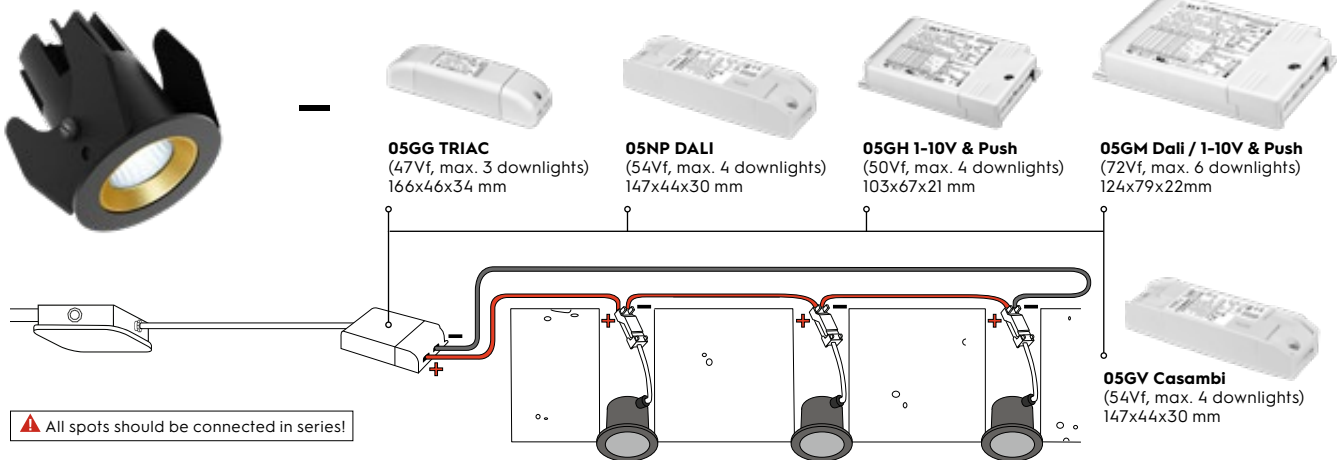

ITEM SPECIFICATIONS (PART A)

Description	Item code CS	Item code WS	Input	Vf	W	Lm	Lm/W	CRI (typ.)	UGR	Pf	Ripple	Inrush current	B-16A Fuse
Strada 35 LVC 500mA 475 Lm 2700K CRI82 Dim	851903XX01E2	851903XX1AE2	500mA	11,9	5,7	475	83	82	15.0	x	x	x	x
Strada 35 LVC 500mA 500 Lm 3000K CRI82 Dim	851903XX72E2	851903XX2AE2	500mA	11,9	5,7	500	88	82	15.2	x	x	x	x
Strada 35 LVC 500mA 525 Lm 4000K CRI82 Dim	851903XX02E2	851903XX3AE2	500mA	11,9	5,7	525	92	82	15.4	x	x	x	x

ITEM SPECIFICATIONS (PART B)

Description	Safety class	Energy class	Weight	Dimensions single carton	Quantity per carton	Expected Lifetime B10 reported (25°C)		
						L70B10	L80B10	L90B10
Strada 35 LVC 500mA 475 Lm 2700K CRI82 Dim	III	F	150 gr	105x105x61 mm	42 pcs	>60.000 hrs	>60.000 hrs	>60.000 hrs
Strada 35 LVC 500mA 500 Lm 3000K CRI82 Dim	III	F	150 gr	105x105x61 mm	42 pcs	>60.000 hrs	>60.000 hrs	>60.000 hrs
Strada 35 LVC 500mA 525 Lm 4000K CRI82 Dim	III	E	150 gr	105x105x61 mm	42 pcs	>60.000 hrs	>60.000 hrs	>60.000 hrs

ITEM SPECIFICATIONS (PART A)

Description	Item code	Input	Watt	Current	Efficiency	Pf	Ripple	Weight	Inrush current	B-16A Fuse
PSU 24W 500mA Triac	05GG03MLME00	220-240V	24W (47Vf)	500mA	85%	0.97	<3%	138 gr	5A 50µS	50 pcs
PSU 27W 500mA Dali	05GJ03MLME00	220-240V	27W (54Vf)	500mA	90%	0.95	<3%	138 gr	5A 50µS	50 pcs
PSU 25W 500mA 1-10V & Push	05GH03MLME00	220-240V	25W (50Vf)	500mA	90%	0.95	<3%	138 gr	5A 50µS	50 pcs
PSU 27W 500mA Casambi	05GV03MLME00	220-240V	27W (54Vf)	500mA	90%	0.95	<3%	139 gr	5A 50µS	50 pcs
PSU 35W 500mA Dali / 1-10V & Push	05GM03MLME00	220-240V	35W (72Vf)	500mA	89%	0.95	<3%	218 gr	20A 400µS	50 pcs

All values are measured at 230V (+/- 7%).

INCLUDING CONNECTION BOX

For installation to a central power supply.

